

## Sailing yacht Hanse 588 Mischief 2.0

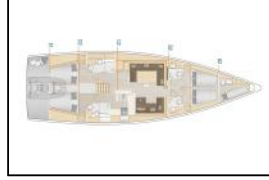

Yacht ID:	10761
Yacht type:	Sailing yacht
Yacht:	<a href="#">Hanse 588 Mischief 2.0</a>
Marina:	Croatia / Sukosan, D-Marin Dalmacija Marina
Production year:	2022
Cabins:	4 + 1
Deposit:	3.000,00 €

**Comfort:** Bed linen, Cockpit cushions, Sundeck cushions,  
**Deck:** Bathing platform, Bimini top, Cockpit table,  
Cockpit/stern, outside shower, Davit,  
Grill/Barbecue/Plancha, Hydraulic gangway, Sprayhood,  
Teak cockpit, Teak deck,  
**Entertainment:** LCD TV, Outdoor speakers, Radio CD player,  
RIB, TV,  
**Galley:** Coffee machine, Freezer, Hot water, Kitchen utensils  
(Galley equipment, cutlery), Oven, Refrigerator, Stove,  
**Interior:** Electric toilet,  
**Navigation:** AIS, Autopilot, Bow thruster, GPS chart plotter -  
cockpit, Navigation (Nautical) charts and nautical guide,  
Tridata,  
**Safety:** VHF radio,  
**Sails:** Electric primary winch, Performance sails, Sails, Self  
tacking jib,  
**Yacht electrics:** Air Conditioning, Battery charger, Generator,  
Heating, Inverter,

### Availability list

18.04. - 25.04.2026 Booked	25.04. - 02.05.2026 3.568 <del>€4.460</del> €	02.05. - 09.05.2026 Booked	09.05. - 16.05.2026 4.112 <del>€5.140</del> €
16.05. - 23.05.2026 Booked	23.05. - 30.05.2026 Booked	30.05. - 13.06.2026 Booked	13.06. - 20.06.2026 Booked
24.06. - 01.07.2026 Booked	04.07. - 18.07.2026 Booked	18.07. - 25.07.2026 On option	25.07. - 01.08.2026 8.016 <del>€10.020</del> €
01.08. - 15.08.2026 Booked	15.08. - 22.08.2026 Booked	22.08. - 29.08.2026 Booked	29.08. - 23.09.2026 Booked
26.09. - 03.10.2026 Booked	03.10. - 10.10.2026 Booked	10.10. - 17.10.2026 3.872 <del>€4.840</del> €	17.10. - 24.10.2026 3.872 <del>€4.840</del> €
24.10. - 31.10.2026 3.872 <del>€4.840</del> €	31.10. - 07.11.2026 3.872 <del>€4.840</del> €	07.11. - 14.11.2026 3.872 <del>€4.840</del> €	14.11. - 21.11.2026 3.872 <del>€4.840</del> €
21.11. - 28.11.2026 3.872 <del>€4.840</del> €	28.11. - 05.12.2026 3.872 <del>€4.840</del> €	05.12. - 12.12.2026 3.872 <del>€4.840</del> €	12.12. - 19.12.2026 3.872 <del>€4.840</del> €
19.12. - 26.12.2026 3.872 <del>€4.840</del> €			