

## Catamaran Bali 4.2 Agma

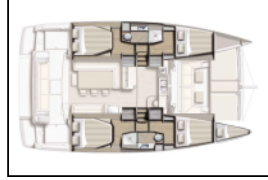

Yacht ID:	10397
Yacht type:	Catamaran
Yacht:	<a href="#">Bali 4.2 Agma</a>
Marina:	Croatia / Marina Mandalina, Sibenik
Production year:	2024
Cabins:	4 + 1
Deposit:	2.500,00 €

**Comfort:** Sun mattresses,  
**Deck:** Anchor with chain, Bimini top, Cockpit table, Cockpit/stern, outside shower, Electric anchor windlass, Grill/Barbecue/Plancha, Main Deck Compass, Spare anchor (Reserve, Auxiliary anchor), Swimming ladder,  
**Entertainment:** Fusion radio, Outdoor speakers,  
**Galley:** Freezer, Hot water, Refrigerator,  
**Interior:** Electric fans in cabins,  
**Navigation:** Autopilot, GPS chart plotter - cockpit, Hand bearing compass, Log/speed instrument, Navigation (Nautical) charts and nautical guide, Navigation set, Pilot book, Wind instrument/Anemometer, Windex,  
**Safety:** Fire extinguisher, First aid kit, Liferaft,  
**Sails:** Electric winch, Lazy bag, Lazy jacks,  
**Yacht electrics:** Battery charger, Inverter, Service batteries, Shore connection 220 V, Solar panels,

### Availability list

06.06. - 13.06.2026 3.824 € <del>4.780</del> €	13.06. - 20.06.2026 Booked	20.06. - 27.06.2026 Booked	27.06. - 04.07.2026 Booked
04.07. - 11.07.2026 Booked	11.07. - 18.07.2026 Booked	18.07. - 25.07.2026 6.464 € <del>8.080</del> €	25.07. - 01.08.2026 Booked
01.08. - 08.08.2026 6.624 € <del>8.280</del> €	08.08. - 15.08.2026 Booked	15.08. - 22.08.2026 Booked	22.08. - 05.09.2026 Booked
05.09. - 12.09.2026 Booked	12.09. - 19.09.2026 Booked	19.09. - 26.09.2026 Booked	26.09. - 03.10.2026 On option
03.10. - 10.10.2026 2.208 € <del>2.760</del> €	10.10. - 17.10.2026 2.016 € <del>2.520</del> €	17.10. - 24.10.2026 2.016 € <del>2.520</del> €	24.10. - 31.10.2026 2.064 € <del>2.580</del> €
31.10. - 07.11.2026 2.064 € <del>2.580</del> €	07.11. - 14.11.2026 2.064 € <del>2.580</del> €	14.11. - 21.11.2026 2.064 € <del>2.580</del> €	21.11. - 28.11.2026 2.064 € <del>2.580</del> €
28.11. - 05.12.2026 2.064 € <del>2.580</del> €	05.12. - 12.12.2026 2.064 € <del>2.580</del> €	12.12. - 19.12.2026 2.064 € <del>2.580</del> €	19.12. - 26.12.2026 2.064 € <del>2.580</del> €
02.01. - 09.01.2027 2.272 € <del>2.840</del> €	09.01. - 16.01.2027 2.272 € <del>2.840</del> €	16.01. - 23.01.2027 2.272 € <del>2.840</del> €	23.01. - 30.01.2027 2.272 € <del>2.840</del> €
30.01. - 06.02.2027 2.272 € <del>2.840</del> €	06.02. - 13.02.2027 2.272 € <del>2.840</del> €	13.02. - 20.02.2027 2.272 € <del>2.840</del> €	20.02. - 27.02.2027 2.272 € <del>2.840</del> €
27.02. - 06.03.2027 2.272 € <del>2.840</del> €			